

# AP060N07K

## N-Channel Power MOSFET

### Product Summary

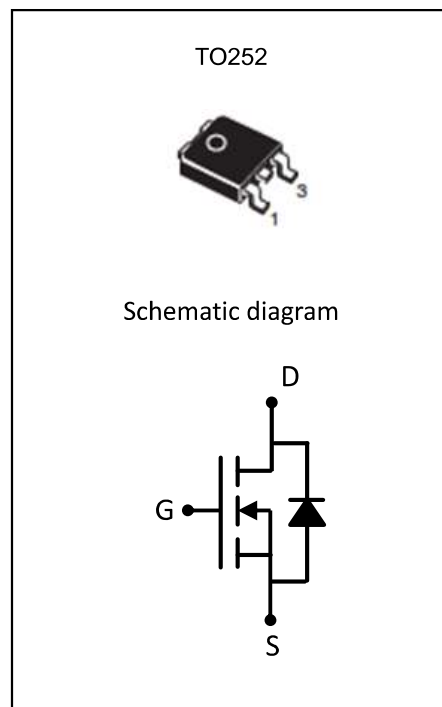
$V_{(BR)DSS}$	$R_{DS(on)}$	$I_D$
70V	5.3mΩ@10V	80A

### Feature

- TrenchFET Power MOSFET
- Fast Switching
- Exceptional on-resistance and maximum DC current capability

### Application

- DC/DC Converter
- Load Switch for Portable Devices
- Battery Switch



### Package Marking and Ordering Information

Device Marking	Device	Device Package	Reel Size	Tape width	Quantity
AP060N07K	AP060N07K	TO-252-3L		-	-

### ABSOLUTE MAXIMUM RATINGS ( $T_a=25^{\circ}\text{C}$ unless otherwise noted)

Parameter	Symbol	Value	Unit
Drain-Source Voltage	$V_{DS}$	70	V
Gate-Source Voltage	$V_{GS}$	+20/-12	V
Continuous Drain Current	$I_D$	80	A
Pulsed Drain Current	$I_{DM}$	330	A
Single Pulse Avalanche Current	EAS	140	mJ
Power Dissipation	$P_D$	30	W
Thermal Resistance from Junction to Ambient	$R_{\theta JA}$	3	$^{\circ}\text{C}/\text{W}$
Junction Temperature	$T_J$	150	$^{\circ}\text{C}$
Storage Temperature	$T_{STG}$	-55~ +150	$^{\circ}\text{C}$

**MOSFET ELECTRICAL CHARACTERISTICS (T<sub>a</sub>=25°C unless otherwise noted)**

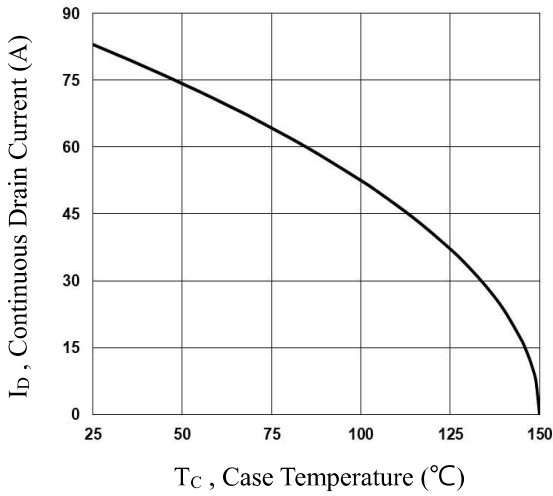
Parameter	Symbol	Test Condition	Min	Type	Max	Unit
<b>Static Characteristics</b>						
Drain-source breakdown voltage	V <sub>(BR)DSS</sub>	V <sub>GS</sub> = 0V, I <sub>D</sub> = -250μA	70	72		V
Zero gate voltage drain current	I <sub>DSS</sub>	V <sub>DS</sub> = 65V, V <sub>GS</sub> = 0V			1	μA
Gate-body leakage current	I <sub>GSS</sub>	V <sub>GS</sub> = +20V, V <sub>DS</sub> = 0V			±100	nA
Gate threshold voltage <sup>(1)</sup>	V <sub>GS(th)</sub>	V <sub>DS</sub> = V <sub>GS</sub> , I <sub>D</sub> = -250μA	2	2.8	4	V
Drain-source on-resistance <sup>(1)</sup>	R <sub>DS(on)</sub>	V <sub>GS</sub> = 10V, I <sub>D</sub> = 40A		5.3	7	mΩ
Forward transconductance <sup>(1)</sup>	g <sub>FS</sub>	V <sub>DS</sub> = 10V, I <sub>D</sub> = 3A		10		S
<b>Dynamic characteristics<sup>(2)</sup></b>						
Input Capacitance	C <sub>iss</sub>	V <sub>DS</sub> = 30V, V <sub>GS</sub> = 0V, f = 1MHz		1910		pF
Output Capacitance	C <sub>oss</sub>			520		
Reverse Transfer Capacitance	C <sub>rss</sub>			30		
<b>Switching characteristics<sup>(2)</sup></b>						
Turn-on delay time	t <sub>d(on)</sub>	V <sub>DD</sub> = 30V, I <sub>D</sub> = 1A, R <sub>L</sub> = 6Ω V <sub>GS</sub> = 10V, R <sub>G</sub> = 1Ω		10.2	20	ns
Turn-on rise time	t <sub>r</sub>			16	32	
Turn-off delay time	t <sub>d(off)</sub>			42	84	
Turn-off fall time	t <sub>f</sub>			38	76	
Total Gate Charge	Q <sub>g</sub>	V <sub>DS</sub> = 30V, I <sub>D</sub> = 10A, V <sub>GS</sub> = 10V		34.7	70	nC
Gate-Source Charge	Q <sub>gs</sub>			4.9		
Gate-Drain Charge	Q <sub>gd</sub>			11		
<b>Source-Drain Diode characteristics</b>						
Diode Forward voltage <sup>(1)</sup>	V <sub>DS</sub>	V <sub>GS</sub> = 0V, I <sub>S</sub> = 1A			1	V

**Notes:**

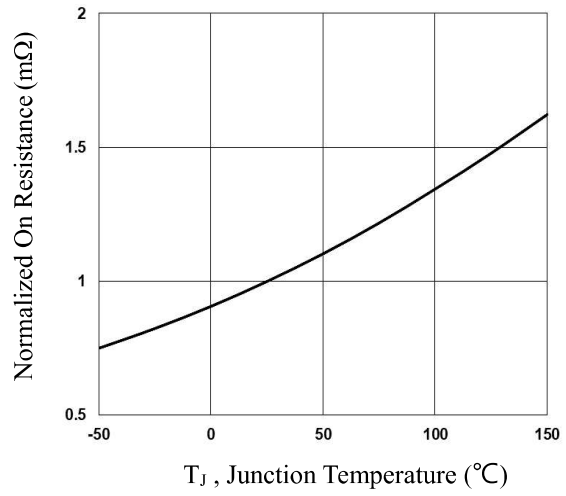
1. Pulse test; pulse width ≤ 300μs, duty cycle ≤ 2%.
2. Guaranteed by design, not subject to production testing.

**AP060N07K**  
**N-Channel Power MOSFET**

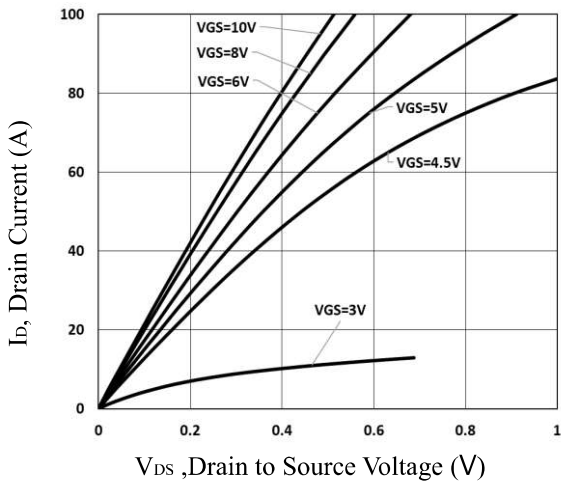
**Typical Electrical and Thermal Characteristics**



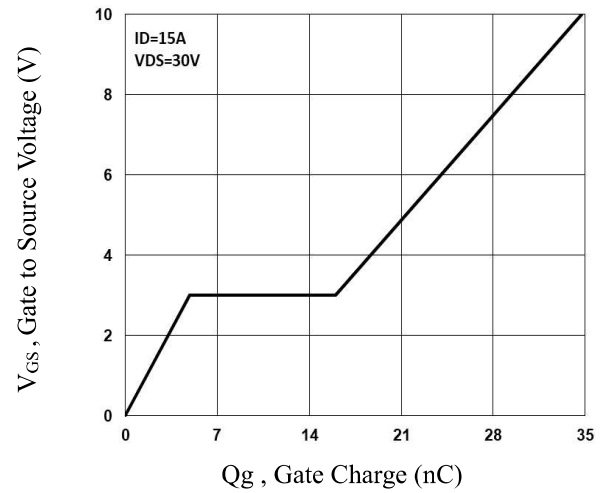
**Fig.1 Continuous Drain Current vs.  $T_C$**



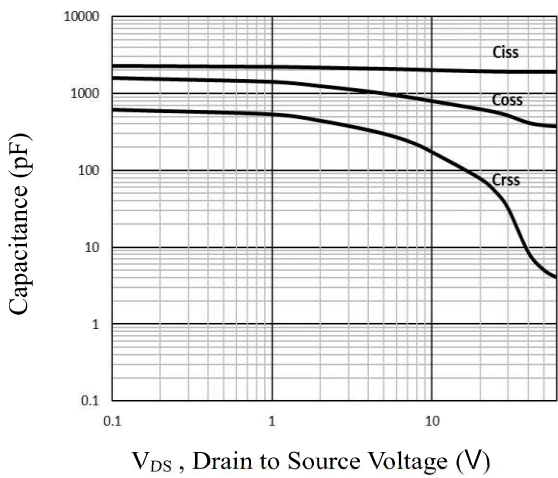
**Fig.2 Normalized  $R_{DS(on)}$  vs.  $T_J$**



**Fig.3 Typical Output Characteristics**

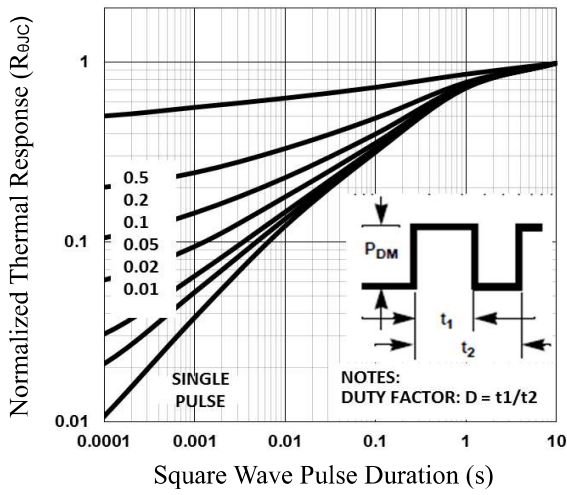


**Fig.4 Gate Charge Characteristics**

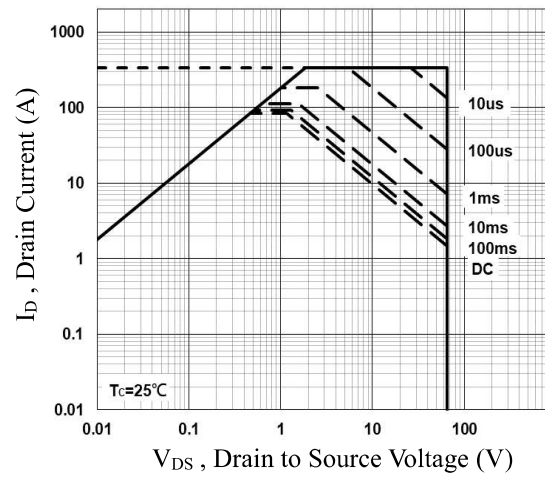


**Fig.5 Capacitance Characteristics**

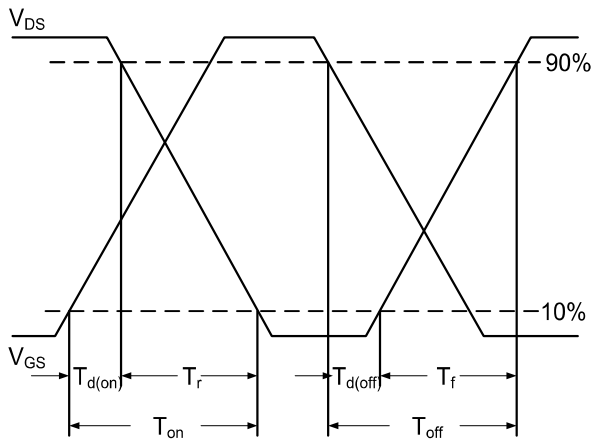
**AP060N07K**  
**N-Channel Power MOSFET**



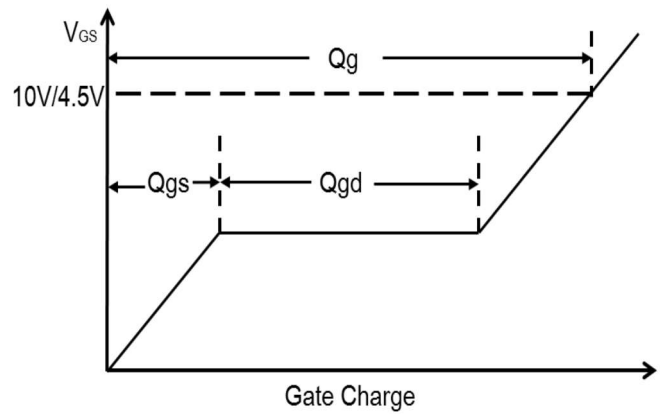
**Fig.6 Normalized Transient Impedance**



**Fig.7 Maximum Safe Operation Area**



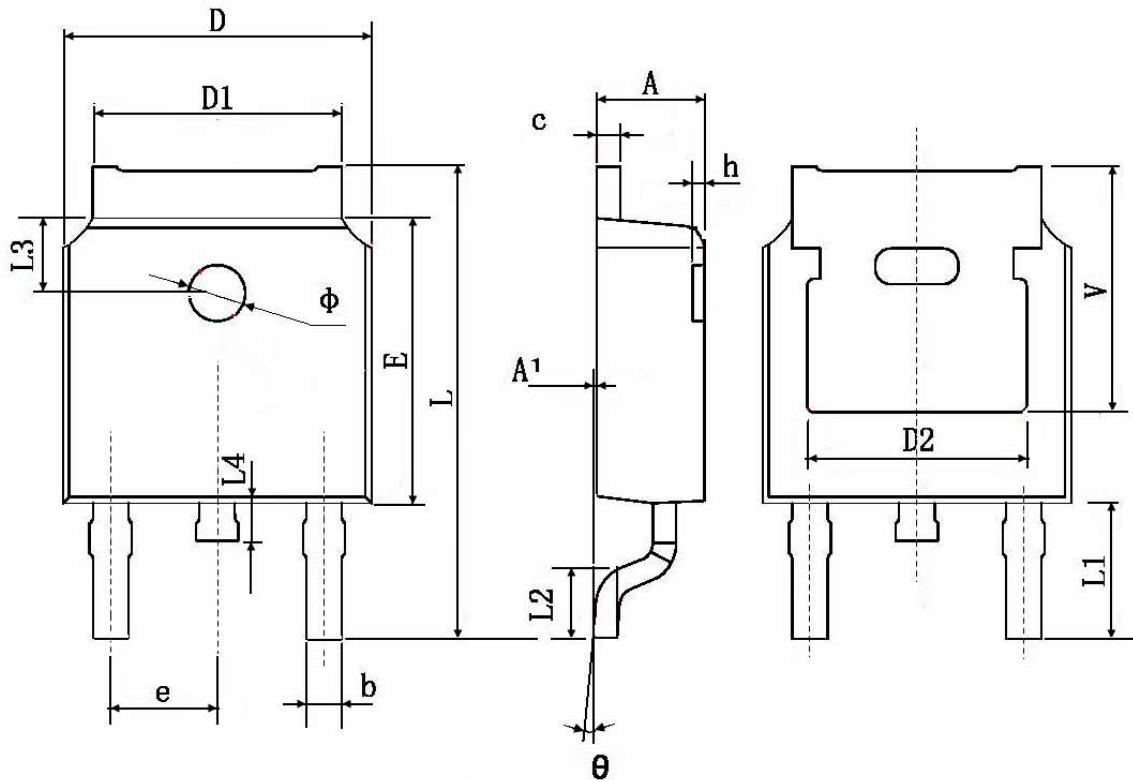
**Fig.8 Switching Time Waveform**



**Fig.9 Gate Charge Waveform**

**AP060N07K**  
**N-Channel Power MOSFET**

**TO-252 Package Information**



Symbol	Dimensions In Millimeters		Dimensions In Inches	
	Min.	Max.	Min.	Max.
A	2.200	2.400	0.087	0.094
A1	0.000	0.127	0.000	0.005
b	0.660	0.860	0.026	0.034
c	0.460	0.580	0.018	0.023
D	6.500	6.700	0.256	0.264
D1	5.100	5.460	0.201	0.215
D2	4.830 TYP.		0.190 TYP.	
E	6.000	6.200	0.236	0.244
e	2.186	2.386	0.086	0.094
L	9.800	10.400	0.386	0.409
L1	2.900 TYP.		0.114 TYP.	
L2	1.400	1.700	0.055	0.067
L3	1.600 TYP.		0.063 TYP.	
L4	0.600	1.000	0.024	0.039
Φ	1.100	1.300	0.043	0.051
θ	0°	8°	0°	8°
h	0.000	0.300	0.000	0.012
V	5.350 TYP.		0.211 TYP.	